



STAUFF Connect

Metric tube connectors, assembly tools
and accessories

Product Catalogue

Version
10/2025



Adjustable Male Stud Elbow (90°) with Lock Nut

FI-WEE

**Whitworth Parallel Pipe Thread (BSPP) /
O-Ring and Retaining Ring (Small)**
FI-WEE-...-R-OK

172

**Metric Parallel Thread /
O-Ring and Retaining Ring (Small)**
FI-WEE-...-M-OK

174

**Metric Parallel Thread /
O-Ring**
FI-WEE-...-M-OR

176

**UN/UNF Thread /
O-Ring**
FI-WEE-...-U-OR

178

Adjustable Male Stud Elbow (45°) with Lock Nut

FI-VEE

**Whitworth Parallel Pipe Thread (BSPP) /
O-Ring and Retaining Ring (Small)**
FI-VEE-...-R-OK

173

**Metric Parallel Thread /
O-Ring and Retaining Ring (Small)**
FI-VEE-...-M-OK

175

**Metric Parallel Thread /
O-Ring**
FI-VEE-...-M-OR

177

**UN/UNF Thread /
O-Ring**
FI-VEE-...-U-OR

179

Adjustable Male Stud Branch Tee with Lock Nut

FI-TEE

**Whitworth Parallel Pipe Thread (BSPP) /
O-Ring and Retaining Ring (Small)**
FI-TEE-...-R-OK

173

**Metric Parallel Thread /
O-Ring and Retaining Ring (Small)**
FI-TEE-...-M-OK

175

**Metric Parallel Thread /
O-Ring**
FI-TEE-...-M-OR

177

**UN/UNF Thread /
O-Ring**
FI-TEE-...-U-OR

179

Adjustable Male Stud Barrel Tee with Lock Nut

FI-LEE

**Whitworth Parallel Pipe Thread (BSPP) /
O-Ring and Retaining Ring (Small)**
FI-LEE-...-R-OK

173

**Metric Parallel Thread /
O-Ring and Retaining Ring (Small)**
FI-LEE-...-M-OK

175



**Metric Parallel Thread /
O-Ring**
FI-LEE-...-M-OR

177

**UN/UNF Thread /
O-Ring**
FI-LEE-...-U-OR

179

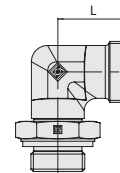
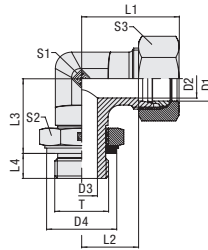
Adjustable Male Stud Elbow (90°) with Lock Nut
Type FI-WEE-...-R-OK • Series L / S



Whitworth Parallel Pipe Thread (BSPP)

O-Ring and Retaining Ring (Small)

Series	Tube OD mm D1	PN bar	Dimensions mm													Torque N-m Thread T	Weight kg ca. per 100	Ordering Codes ³
			Thread T	D2	D3	D4	L	L1 ¹	L2	L3	L4	S1	S2	S3				
L	6	315	G 1/8	4	4	14,8	21	29	14	20	7	14	14	14	25	4,06	FI-WEE-06LR-OK-B-W3	
	8	315	G 1/4	6	5	19,8	23	31	16	25	9	14	19	17	50	6,34	FI-WEE-08LR-OK-B-W3	
	10	315	G 1/4	8	5	19,8	24	32	17	27	9	19	19	19	50	9,17	FI-WEE-10LR-OK-B-W3	
	12	250	G 3/8	10	8	22,8	26	34	19	28	9	19	22	22	80	10,39	FI-WEE-12LR-OK-B-W3	
	15	250	G 1/2	12	12	27,8	28	36	21	29	13	22	27	27	105	15,73	FI-WEE-15LR-OK-B-W3	
	18	250	G 1/2	15	12	27,8	31	40	23,5	33	13	27	27	32	105	22,29	FI-WEE-18LR-OK-B-W3	
	22	160	G 3/4	19	16	32,8	35	44	27,5	38	13	30	36	36	220	33,01	FI-WEE-22LR-OK-B-W3	
	28	160	G 1	24	20	40,8	38	47	30,5	44	15	36	41	41	370	50,60	FI-WEE-28LR-OK-B-W3	
	35	160	G 1 1/4	30	25	50,8	48	59	37,5	55	15	50	50	50	500	115,30	FI-WEE-35LR-OK-B-W3	
42	160	G 1 1/2	36	32	55,8	49	61	38	59	15	50	55	60	600	112,50	FI-WEE-42LR-OK-B-W3		
S	6	315	G 1/4	4	5	19,8	22	30	15	25	9	14	19	17	50	6,62	FI-WEE-06SR-OK-B-W3	
	8	315	G 1/4	5	5	19,8	24	32	17	27	9	19	19	19	50	9,70	FI-WEE-08SR-OK-B-W3	
	10	315	G 3/8	7	8	22,8	25	34	17,5	28	9	19	22	22	80	10,96	FI-WEE-10SR-OK-B-W3	
	12	250	G 3/8	8	8	22,8	29	38	21,5	31	9	22	22	24	80	14,98	FI-WEE-12SR-OK-B-W3	
	16	250	G 1/2	12	12	27,8	33	43	24,5	33	13	27	27	30	105	23,56	FI-WEE-16SR-OK-B-W3	
	20	250	G 3/4	16	16	32,8	38	49	27,5	39	12	30	36	36	220	36,41	FI-WEE-20SR-OK-B-W3	
	25	250	G 1	20	20	40,8	42	54	30	45	14	36	41	46	370	56,20	FI-WEE-25SR-OK-B-W3	
	30	160	G 1 1/4	25	25	50,8	49	62	35,5	55	15	50	50	50	500	120,20	FI-WEE-30SR-OK-B-W3	
	38	160	G 1 1/2	32	32	55,8	50	65	34	59	15	50	55	60	600	120,30	FI-WEE-38SR-OK-B-W3	

¹ Approximate dimension in assembled condition.

² Weight excluding cutting ring and union nut.

³ Standard scope of delivery: Fitting body only.

Standard seal material is NBR (Buna-N®).

Male stud acc. to ISO 1179-3 (Type H)

Port acc. to ISO 1179-1

Torque recommendations for Steel mating material.

Male threaded studs were designed for female threaded ports in components made of steel. For applications with components made of softer mating materials (e.g. Aluminium), the use of connectors with additionally rolled male threads is recommended.

Please contact STAUFF prior to the assembly for further information.

Ordering Codes

***FI-WEE*-10*L*R*-OK*-B*-W3*-MS**

- * Adjustable Male Stud Elbow (90°) with Lock Nut **FI-WEE**
- * Outside Tube Diameter (in mm) **-10**
- * Series **L** Light Series
S Heavy Series
- * Thread Type **R** Whitworth Parallel Pipe Thread (BSPP)

- * Seal Type **-OK** O-Ring and Retaining Ring (Small)
- * Seal Material **-B** NBR (Buna-N®)
-V FKM (Viton®)
- * Material Code **-W3** Steel, zinc/nickel-plated
- Please contact STAUFF for alternative materials and surface finishings.

- * Assembling / Kitting **-** Fitting body only
- MS** Fitting body supplied with cutting ring and union nut
- MSV** Fitting body supplied with soft-sealing cutting ring and union nut

If required, please indicate special sizes, e.g. R1/8!

**Adjustable Male Stud Elbow (45°) with Lock Nut
Type FI-VEE-...-R-OK • Series L / S**
**Adjustable Male Stud Branch Tee with Lock Nut
Type FI-TEE-...-R-OK • Series L / S**
**Adjustable Male Stud Barrel Tee with Lock Nut
Type FI-LEE-...-R-OK • Series L / S**
Type FI-VEE-...-R-OK

Whitworth Parallel Pipe Thread (BSPP)
O-Ring and Retaining Ring (Small)

Male stud acc. to ISO 1179-3 (Type H)
Port acc. to ISO 1179-1

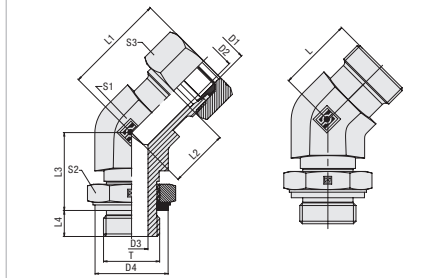

Dimensions L, L1, L2 and L3 deviating from the dimension table on the left.

Type FI-TEE-...-R-OK

Whitworth Parallel Pipe Thread (BSPP)
O-Ring and Retaining Ring (Small)

Male stud acc. to ISO 1179-3 (Type H)
Port acc. to ISO 1179-1

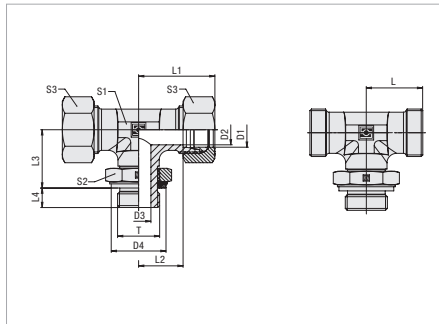
Type FI-LEE-...-R-OK

Whitworth Parallel Pipe Thread (BSPP)
O-Ring and Retaining Ring (Small)

Male stud acc. to ISO 1179-3 (Type H)
Port acc. to ISO 1179-1

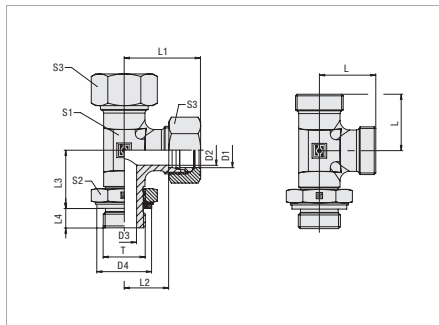

Male threaded studs were designed for female threaded ports in components made of steel. For applications with components made of softer mating materials (e.g. Aluminium), the use of connectors with additionally rolled male threads is recommended.

Please contact STAUFF prior to the assembly for further information.

Connecting Parts

Cutting Ring
Type **FI-DS** Page 28



Soft-Sealing Cutting Ring
Type **FI-WDDS** Page 29



Support Sleeve
Type **FI-VH** Page 31



STAUFF Form EVO Sealing Ring
Type **FI-FD** Page 32



Union Nut
Type **FI-M** Page 33



37° Flared Tube Fitting Set
Type **FI-AB** Page 37

Spare Parts / Accessories



O-Ring
Type **O-RING** Page 239



Retaining Ring (Small)
Type **FI-KR** Page 247

J

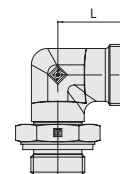
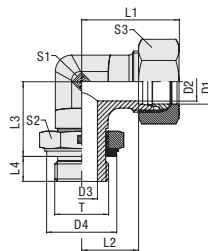
Adjustable Male Stud Elbow (90°) with Lock Nut Type FI-WEE-...-M-OK • Series L / S



Metric Parallel Thread

O-Ring and Retaining Ring (Small)

Series	Tube OD mm D1	PN bar	Dimensions mm													Torque N-m Thread T	Weight kg ca. per 100	Ordering Codes ³
			Thread T	D2	D3	D4	L	L1 ¹	L2	L3	L4	S1	S2	S3				
L	6	315	M 10 x 1	4	4	14,8	21	29	14	20	7	14	14	14	18	4,42	FI-WEE-06LM-OK-B-W3	
	8	315	M 12 x 1,5	6	4	17,8	23	31	16	23,5	10	14	17	17	35	5,14	FI-WEE-08LM-OK-B-W3	
	10	315	M 14 x 1,5	8	5	19,8	24	32	17	27	10	19	19	19	55	8,60	FI-WEE-10LM-OK-B-W3	
	12	315	M 16 x 1,5	10	7	22,8	26	34	19	27	10	19	22	22	80	10,44	FI-WEE-12LM-OK-B-W3	
	15	315	M 18 x 1,5	12	8	24,8	28	36	21	29	11	22	24	27	105	14,89	FI-WEE-15LM-OK-B-W3	
	18	250	M 22 x 1,5	15	12	27,8	31	40	23,5	36	12	27	27	32	125	23,93	FI-WEE-18LM-OK-B-W3	
	22	160	M 27 x 2	19	16	32,8	35	44	27,5	38	14	30	32	36	220	30,36	FI-WEE-22LM-OK-B-W3	
	28	160	M 33 x 2	24	20	40,8	38	47	30,5	47	14	36	41	41	370	51,70	FI-WEE-28LM-OK-B-W3	
	35	160	M 42 x 2	30	25	50,8	48	59	37,5	58	14	50	50	50	500	106,10	FI-WEE-35LM-OK-B-W3	
42	160	M 48 x 2	36	32	55,8	49	61	38	58,5	16	50	55	60	600	101,60	FI-WEE-42LM-OK-B-W3		
S	6	315	M 12 x 1,5	4	4	17,8	22	30	15	23,5	10	14	17	17	35	6,43	FI-WEE-06SM-OK-B-W3	
	8	315	M 14 x 1,5	5	5	19,8	24	32	17	27	10	19	19	19	55	9,06	FI-WEE-08SM-OK-B-W3	
	10	315	M 16 x 1,5	7	7	22,8	25	34	17,5	26	11	19	22	22	80	11,02	FI-WEE-10SM-OK-B-W3	
	12	315	M 18 x 1,5	8	8	24,8	29	38	21,5	28	12	22	24	24	105	15,90	FI-WEE-12SM-OK-B-W3	
	16	250	M 22 x 1,5	12	12	27,8	33	43	24,5	34	14	27	27	30	125	25,14	FI-WEE-16SM-OK-B-W3	
	20	250	M 27 x 2	16	16	32,8	38	49	27,5	36	16	30	32	36	220	38,45	FI-WEE-20SM-OK-B-W3	
	25	250	M 33 x 2	20	20	40,8	42	54	30	45	16	36	41	46	370	53,82	FI-WEE-25SM-OK-B-W3	
	30	160	M 42 x 2	25	25	50,8	49	62	35,5	55	17	50	50	50	500	110,10	FI-WEE-30SM-OK-B-W3	
	38	160	M 48 x 2	32	32	55,8	50	65	34	55,5	19	50	55	60	600	109,30	FI-WEE-38SM-OK-B-W3	

¹ Approximate dimension in assembled condition.

² Weight excluding cutting ring and union nut.

³ Standard scope of delivery: Fitting body only.

Standard seal material is NBR (Buna-N®).

Port acc. to ISO 9974-1

Torque recommendations for Steel mating material.

Male threaded studs were designed for female threaded ports in components made of steel. For applications with components made of softer mating materials (e.g. Aluminium), the use of connectors with additionally rolled male threads is recommended.

Please contact STAUFF prior to the assembly for further information.

Ordering Codes

***FI-WEE*-10*L*M*-OK*-B*-W3*-MS**

- * Adjustable Male Stud Elbow (90°) with Lock Nut **FI-WEE**
- * Outside Tube Diameter (in mm) **-10**
- * Series Light Series **L**
Heavy Series **S**
- * Thread Type Metric Parallel Thread **M**

If required, please indicate special sizes, e.g. M26x1.5!

- * Seal Type O-Ring and Retaining Ring (Small) **-OK**
- * Seal Material NBR (Buna-N®) **-B**
FKM (Viton®) **-V**
- * Material Code Steel, zinc/nickel-plated **-W3**

Please contact STAUFF for alternative materials and surface finishings.

- * Assembling / Kitting Fitting body only **-**
- Fitting body supplied with cutting ring and union nut **-MS**
- Fitting body supplied with soft-sealing cutting ring and union nut **-MSV**

Adjustable Male Stud Elbow (45°) with Lock Nut
Type FI-VEE-...-M-OK • Series L / S
Adjustable Male Stud Branch Tee with Lock Nut
Type FI-TEE-...-M-OK • Series L / S
Adjustable Male Stud Barrel Tee with Lock Nut
Type FI-LEE-...-M-OK • Series L / S
Type FI-VEE-...-M-OK
Metric Parallel Thread
O-Ring and Retaining Ring (Small)

Port acc. to ISO 9974-1

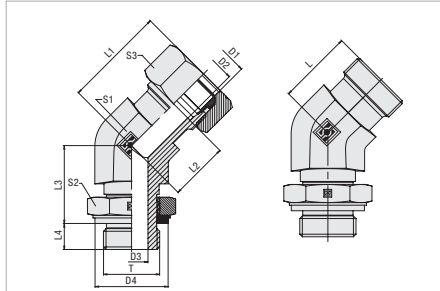

Dimensions L, L1, L2 and L3 deviating from the dimension table on the left.

Type FI-TEE-...-M-OK
Metric Parallel Thread
O-Ring and Retaining Ring (Small)

Port acc. to ISO 9974-1

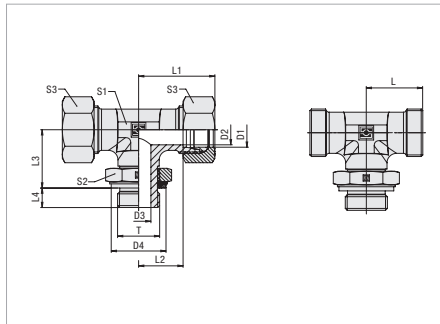
Type FI-LEE-...-M-OK
Metric Parallel Thread
O-Ring and Retaining Ring (Small)

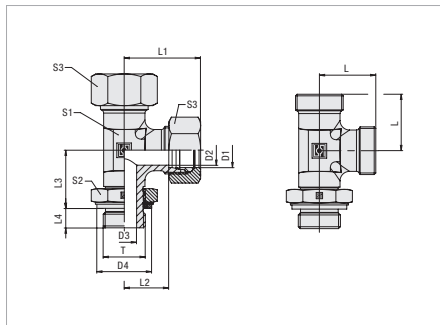

Port acc. to ISO 9974-1





Male threaded studs were designed for female threaded ports in components made of steel. For applications with components made of softer mating materials (e.g. Aluminium), the use of connectors with additionally rolled male threads is recommended.

Please contact STAUFF prior to the assembly for further information.

Connecting Parts

-  Cutting Ring
Type **FI-DS** Page 28
-  Soft-Sealing Cutting Ring
Type **FI-WDDS** Page 29
-  Support Sleeve
Type **FI-VH** Page 31

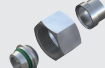
-  STAUFF Form EVO Sealing Ring
Type **FI-FD** Page 32
-  Union Nut
Type **FI-M** Page 33
-  37° Flared Tube Fitting Set
Type **FI-AB** Page 37

Spare Parts / Accessories

-  O-Ring
Type **O-RING** Page 239
-  Retaining Ring (Small)
Type **FI-KR** Page 247

J

Adjustable Male Stud Elbow (90°) with Lock Nut Type FI-WEE-...-M-OR • Series L / S

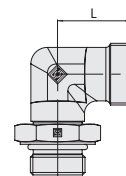
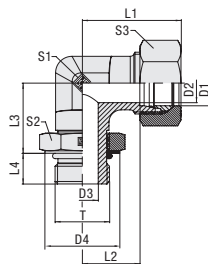

Metric Parallel Thread

O-Ring

Series	Tube OD mm	PN bar	Dimensions mm													Torque N-m	Weight kg ca. per 100	Ordering Codes ³
			Thread T	D2	D3	D4	L	L1 ¹	L2	L3	L4	S1	S2	S3	Thread T			
L	6	315	M 10 x 1	4	4	14,5	21	29	14	20	7	14	14	14	15	5,16	FI-WEE-06LM-OR-B-W3	
	8	315	M 12 x 1,5	6	4	17,5	23	31	16	23,5	10	14	17	17	25	5,44	FI-WEE-08LM-OR-B-W3	
	10	315	M 14 x 1,5	8	5	19,5	24	32	17	27	10	19	19	19	35	9,00	FI-WEE-10LM-OR-B-W3	
	12	315	M 16 x 1,5	10	7	22,5	26	34	19	27	10	19	22	22	40	10,23	FI-WEE-12LM-OR-B-W3	
	15	315	M 18 x 1,5	12	8	24,5	28	36	21	29	11	22	24	27	45	14,59	FI-WEE-15LM-OR-B-W3	
	18	250	M 22 x 1,5	15	12	27,5	31	40	23,5	36	12	27	27	32	60	23,09	FI-WEE-18LM-OR-B-W3	
	22	160	M 27 x 2	19	16	32,5	35	44	27,5	38	14	30	32	36	100	39,11	FI-WEE-22LM-OR-B-W3	
	28	160	M 33 x 2	24	20	41,5	38	47	30,5	47	14	36	41	41	160	61,54	FI-WEE-28LM-OR-B-W3	
	35	160	M 42 x 2	30	25	50,5	48	59	37,5	58	14	50	50	50	210	131,90	FI-WEE-35LM-OR-B-W3	
42	160	M 48 x 2	36	32	55,5	49	61	38	58,5	16	50	55	60	260	136,43	FI-WEE-42LM-OR-B-W3		
S	6	315	M 12 x 1,5	4	4	17,5	22	30	15	23,5	10	14	17	17	35	7,62	FI-WEE-06SM-OR-B-W3	
	8	315	M 14 x 1,5	5	5	19,5	24	32	17	27	10	19	19	19	45	11,98	FI-WEE-08SM-OR-B-W3	
	10	250	M 16 x 1,5	7	7	22,5	25	34	17,5	26	11	19	22	22	55	10,81	FI-WEE-10SM-OR-B-W3	
	12	250	M 18 x 1,5	8	8	24,5	29	38	21,5	28	12	22	24	24	70	15,60	FI-WEE-12SM-OR-B-W3	
	16	250	M 22 x 1,5	12	12	27,5	33	43	24,5	34	14	27	27	30	100	24,52	FI-WEE-16SM-OR-B-W3	
	20	250	M 27 x 2	16	16	32,5	38	49	27,5	36	16	30	32	36	170	33,16	FI-WEE-20SM-OR-B-W3	
	25	160	M 33 x 2	20	20	41,5	42	54	30	45	16	36	41	46	310	56,70	FI-WEE-25SM-OR-B-W3	
	30	160	M 42 x 2	25	25	50,5	49	62	35,5	55	17	50	50	50	330	144,57	FI-WEE-30SM-OR-B-W3	
38	160	M 48 x 2	32	32	55,5	50	65	34	55,5	19	50	55	60	420	152,80	FI-WEE-38SM-OR-B-W3		

¹ Approximate dimension in assembled condition.

² Weight excluding cutting ring and union nut.

³ Standard scope of delivery: Fitting body only.

Standard seal material is NBR (Buna-N®).

Male stud according to ISO 6149-2/-3

Port according to ISO 6149-1

Torque recommendations for Steel mating material.

Male threaded studs were designed for female threaded ports in components made of steel. For applications with components made of softer mating materials (e.g. Aluminium), the use of connectors with additionally rolled male threads is recommended.

Please contact STAUFF prior to the assembly for further information.

Ordering Codes

***FI-WEE*-10*L*M*-OR*-B*-W3*-MS**

- * Adjustable Male Stud Elbow (90°) with Lock Nut **FI-WEE**
- * Outside Tube Diameter (in mm) **-10**
- * Series **L** Light Series
S Heavy Series
- * Thread Type **M** Metric Parallel Thread

If required, please indicate special sizes, e.g. M26x1.5!

- * Seal Type **-OR** O-Ring
 - * Seal Material **-B** NBR (Buna-N®)
-V FKM (Viton®)
 - * Material Code **-W3** Steel, zinc/nickel-plated
- Please contact STAUFF for alternative materials and surface finishings.

- * Assembling / Kitting Fitting body only **-**
- Fitting body supplied with cutting ring and union nut **-MS**
- Fitting body supplied with soft-sealing cutting ring and union nut **-MSV**

**Adjustable Male Stud Elbow (45°) with Lock Nut
Type FI-VEE-...-M-OR • Series L / S**
**Adjustable Male Stud Branch Tee with Lock Nut
Type FI-TEE-...-M-OR • Series L / S**
**Adjustable Male Stud Barrel Tee with Lock Nut
Type FI-LEE-...-M-OR • Series L / S**
Type FI-VEE-...-M-OR
**Metric Parallel Thread
O-Ring**

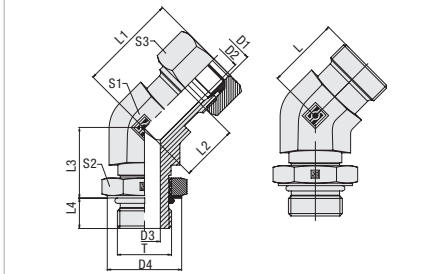
 Male stud according to ISO 6149-2/-3
 Port according to ISO 6149-1

Dimensions L, L1, L2 and L3 deviating from the dimension table on the left.

Type FI-TEE-...-M-OR
**Metric Parallel Thread
O-Ring**

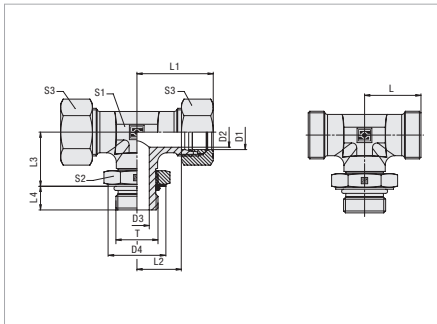

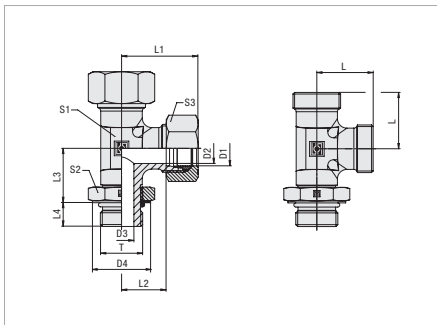
 Male stud according to ISO 6149-2/-3
 Port according to ISO 6149-1

Type FI-LEE-...-M-OR
**Metric Parallel Thread
O-Ring**



 Male stud according to ISO 6149-2/-3
 Port according to ISO 6149-1

Male threaded studs were designed for female threaded ports in components made of steel. For applications with components made of softer mating materials (e.g. Aluminium), the use of connectors with additionally rolled male threads is recommended.

Please contact STAUFF prior to the assembly for further information.

Connecting Parts

-  Cutting Ring
Type **FI-DS** Page 28
-  Soft-Sealing Cutting Ring
Type **FI-WDDS** Page 29
-  Support Sleeve
Type **FI-VH** Page 31

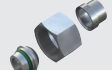
-  STAUFF Form EVO Sealing Ring
Type **FI-FD** Page 32
-  Union Nut
Type **FI-M** Page 33
-  37° Flared Tube Fitting Set
Type **FI-AB** Page 37

Spare Parts / Accessories

-  O-Ring
Type **O-RING** Page 239

Adjustable Male Stud Elbow (90°) with Lock Nut
Type FI-WEE-...-U • Series L / S

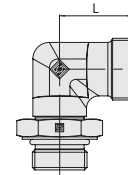
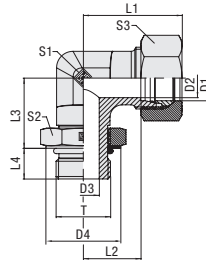

UN/UNF Thread

O-Ring

Series	Tube OD mm D1	PN bar	Dimensions mm													Torque N-m Thread T	Weight kg ca. per 100	Ordering Codes ³
			Thread T	D2	D3	D4	L	L1 ¹	L2	L3	L4	S1	S2	S3				
L	6	315	7/16-20 UNF	4	4,5	16,5	21	29	14	21	11	14	17	14	18	5,02	FI-WEE-06L7/16U-OR-B-W3	
	8	315	7/16-20 UNF	6	4,5	16,5	23	31	16	21	11	14	17	17	18	5,16	FI-WEE-08L7/16U-OR-B-W3	
	10	315	9/16-18 UNF	8	7,5	20,2	24	32	17	25	12	19	19	19	34	14,99	FI-WEE-10L9/16U-OR-B-W3	
	12	315	9/16-18 UNF	10	7,5	20,2	26	34	19	25,5	12	19	19	22	34	15,29	FI-WEE-12L9/16U-OR-B-W3	
	15	315	3/4-16 UNF	12	10	25,7	28	36	21	30	14	22	24	27	55	15,03	FI-WEE-15L3/4U-OR-B-W3	
	18	250	7/8-14 UNF	15	12,5	29,3	31	40	23,5	35	16	27	27	32	80	24,03	FI-WEE-18L7/8U-OR-B-W3	
	22	160	1 1/16-12 UN	19	15,5	36,7	35	44	27,5	39	18	30	36	36	100	35,96	FI-WEE-22L1-1/16U-OR-B-W3	
	28	160	1 5/16-12 UN	24	21,5	44	38	47	30,5	43	18	36	41	41	150	49,38	FI-WEE-28L1-5/16U-OR-B-W3	
	35	160	1 5/8-12 UN	30	27,5	55	48	59	37,5	50	18	50	50	50	290	106,22	FI-WEE-35L1-5/8U-OR-B-W3	
42	160	1 7/8-12 UN	36	33,5	62,3	49	61	37,89	52	18	50	55	60	325	101,73	FI-WEE-42L1-7/8U-OR-B-W3		
S	6	315	7/16-20 UNF	4	4,5	16,5	22	30	15	21	11	14	17	17	20	5,92	FI-WEE-06S7/16U-OR-B-W3	
	8	315	9/16-18 UNF	5	7,5	20,2	24	32	17	25	12	19	19	19	46	9,45	FI-WEE-08S9/16U-OR-B-W3	
	10	315	9/16-18 UNF	7	7,5	20,2	25	34	17,5	25,5	12	19	19	22	46	9,80	FI-WEE-10S9/16U-OR-B-W3	
	12	315	3/4-16 UNF	8	10	25,7	29	38	21,5	30	14	22	24	24	80	16,06	FI-WEE-12S3/4U-OR-B-W3	
	16	250	7/8-14 UNF	12	12,5	29,3	33	43	24,5	35	16	27	27	30	80	25,18	FI-WEE-16S7/8U-OR-B-W3	
	20	250	1 1/16-12 UN	16	15,5	36,7	38	49	27,5	39	18	30	36	36	185	38,53	FI-WEE-20S1-1/16U-OR-B-W3	
	25	160	1 1/16-12 UN	20	15,5	36,7	42	54	30	43	18	36	36	46	185	53,90	FI-WEE-25S1-1/16U-OR-B-W3	
	30	160	1 5/8-12 UN	25	27,5	55	49	62	35,5	50	18	50	50	50	340	110,22	FI-WEE-30S1-5/8U-OR-B-W3	
	38	160	1 7/8-12 UN	32	33,5	62,3	50	65	33,9	52	18	50	55	60	415	109,43	FI-WEE-38S1-7/8U-OR-B-W3	

¹ Approximate dimension in assembled condition.

² Weight excluding cutting ring and union nut.

³ Standard scope of delivery: Fitting body only.

Standard seal material is NBR (Buna-N®).

Male stud acc. to ISO 11926-2/-3
 Port acc. to ISO 11926-1

Torque recommendations for Steel mating material.

Male threaded studs were designed for female threaded ports in components made of steel. For applications with components made of softer mating materials (e.g. Aluminium), the use of connectors with additionally rolled male threads is recommended.

Please contact STAUFF prior to the assembly for further information.

Ordering Codes

***FI-WEE*-10*L*9/16*U*-OR*-B*-W3*-MS**

- * Adjustable Male Stud Elbow (90°) with Lock Nut **FI-WEE**
- * Outside Tube Diameter (in mm) **-10**
- * Series Light Series **L**
Heavy Series **S**
- * Thread Size acc. to dimension table **9/16**

Please always indicate thread sizes, e.g. 9/16!

- * Thread Type UN/UNF Thread with O-Ring **U**
 - * Seal Material NBR (Buna-N®) **-B**
FKM (Viton®) **-V**
 - * Material Code Steel, zinc/nickel-plated **-W3**
- Please contact STAUFF for alternative materials and surface finishings.

- * Assembling / Kitting Fitting body only **-**
- Fitting body supplied with cutting ring and union nut **-MS**
- Fitting body supplied with soft-sealing cutting ring and union nut **-MSV**

**Adjustable Male Stud Elbow (45°) with Lock Nut
Type FI-VEE-...-U • Series L / S**
**Adjustable Male Stud Branch Tee with Lock Nut
Type FI-TEE-...-U • Series L / S**
**Adjustable Male Stud Barrel Tee with Lock Nut
Type FI-LEE-...-U • Series L / S**
Type FI-VEE-...-U
**UN/UNF Thread
O-Ring**

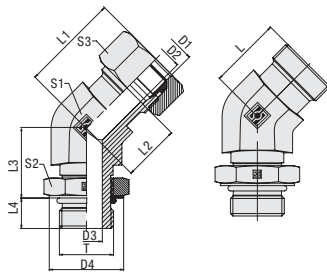
 Male stud according to ISO 6149-2/-3
 Port according to ISO 6149-1

Dimensions L, L1, L2 and L3 deviating from the dimension table on the left.

Type FI-TEE-...-U
**UN/UNF Thread
O-Ring**

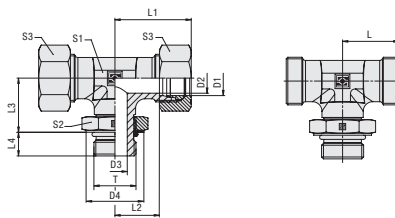
 Male stud according to ISO 6149-2/-3
 Port according to ISO 6149-1

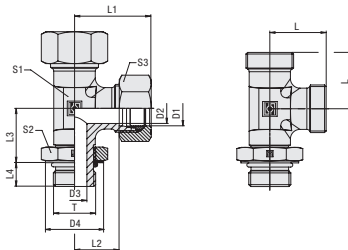
Type FI-LEE-...-U
**UN/UNF Thread
O-Ring**

 Male stud according to ISO 6149-2/-3
 Port according to ISO 6149-1

Male threaded studs were designed for female threaded ports in components made of steel. For applications with components made of softer mating materials (e.g. Aluminium), the use of connectors with additionally rolled male threads is recommended.

Please contact STAUFF prior to the assembly for further information.

Connecting Parts

 Cutting Ring
 Type **FI-DS** Page 28

 Soft-Sealing Cutting Ring
 Type **FI-WDDS** Page 29

 Support Sleeve
 Type **FI-VH** Page 31

 STAUFF Form EVO Sealing Ring
 Type **FI-FD** Page 32

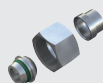
 Union Nut
 Type **FI-M** Page 33

 37° Flared Tube Fitting Set
 Type **FI-AB** Page 37

Spare Parts / Accessories

 O-Ring
 Type **O-RING** Page 239