



# STAUFF Connect





Metric tube connectors, assembly tools  
and accessories

---

Product Catalogue

Version  
10/2025



	<p><b>Straight Weld Fitting</b> FI-AS</p>	114
	<p><b>Elbow Weld Fitting</b> FI-WAS</p>	115
	<p><b>24° Weld Cone with O-Ring</b> FI-SN</p>	116
	<p><b>24° Weld Cone Reducer with O-Ring</b> FI-SNR</p>	118
	<p><b>Straight Weld Fitting for Tubes</b> FI-ASV</p>	120

## Straight Weld Fitting Type FI-AS ▪ Series L / S

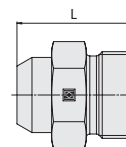
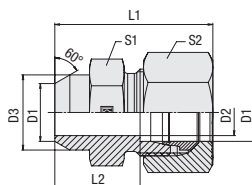

### Ordering Codes

#### \*FI-AS\*-10\*L\*-W159\*-MS

* Straight Weld Fitting		<b>FI-AS</b>
* Outside Tube Diameter D1 (in mm)		<b>-10</b>
* Series	Light Series	<b>L</b>
	Heavy Series	<b>S</b>
* Material Code	Steel, phosphated	<b>-W2</b>
	Fitting body: Steel, phosphated	<b>-W159</b>
	Connecting parts: Steel, zinc/nickel-plated	
Please contact STAUFF for alternative materials and surface finishings.		
* Assembling / Kitting	Fitting body only	<b>—</b>
	Fitting body supplied with cutting ring and union nut	<b>-MS</b>
	Fitting body supplied with soft-sealing cutting ring and union nut	<b>-MSV</b>

Series	Tube OD mm D1	PN bar	Dimensions mm							Weight kg ca. per 100	Ordering Codes <sup>3</sup>
			D2	D3	L	L1 <sup>1</sup>	L2	S1	S2		
L	6	500	4	10	21	29	14	12	14	1,06	FI-AS-06L-W2
	8	500	6	12	23	31	16	14	17	1,52	FI-AS-08L-W2
	10	500	8	14	25	33	18	17	19	2,20	FI-AS-10L-W2
	12	400	10	16	25	33	18	19	22	2,57	FI-AS-12L-W2
	15	400	12	19	29	37	22	22	27	4,37	FI-AS-15L-W2
	18	400	15	22	31	40	23,5	27	32	6,70	FI-AS-18L-W2
	22	250	19	27	36	45	28,5	32	36	9,87	FI-AS-22L-W2
	28	250	24	32	38	47	30,5	41	41	16,10	FI-AS-28L-W2
	35	250	30	40	43	54	32,5	46	50	23,43	FI-AS-35L-W2
	42	250	36	46	46	58	35	55	60	32,82	FI-AS-42L-W2
S	6	800	4	11	26	34	19	14	17	2,06	FI-AS-06S-W2
	8	800	5	13	28	36	21	17	19	3,12	FI-AS-08S-W2
	10	800	7	15	30	39	22,5	19	22	4,12	FI-AS-10S-W2
	12	630	8	17	32	41	24,5	22	24	4,80	FI-AS-12S-W2
	14	630	10	19	35	45	27	24	27	7,11	FI-AS-14S-W2
	16	630	12	21	35	45	26,5	27	30	8,36	FI-AS-16S-W2
	20	400	16	26	40	51	29,5	32	36	13,01	FI-AS-20S-W2
	25	400	20	31	44	56	32	41	46	22,16	FI-AS-25S-W2
	30	400	25	36	49	62	35,5	46	50	29,80	FI-AS-30S-W2
	38	400	32	44	54	69	38	55	60	45,26	FI-AS-38S-W2

<sup>1</sup> Approximate dimension in assembled condition.

<sup>2</sup> Weight excluding cutting ring and union nut.

<sup>3</sup> Standard scope of delivery: Fitting body only.

### Connecting Parts

	Cutting Ring Type <b>FI-DS</b>	Page 28
	Soft-Sealing Cutting Ring Type <b>FI-WDDS</b>	Page 29
	Support Sleeve Type <b>FI-VH</b>	Page 31
	STAUFF Form EVO Sealing Ring Type <b>FI-FD</b>	Page 32
	Union Nut Type <b>FI-M</b>	Page 33
	37° Flared Tube Fitting Set Type <b>FI-AB</b>	Page 37

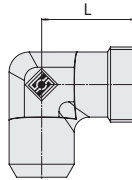
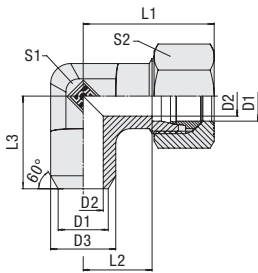
**Elbow Weld Fitting  
Type FI-WAS • Series L / S**

Series	Tube OD mm	PN bar	Dimensions mm								Weight kg ca. per 100	Ordering Codes <sup>3</sup>
			D1	D2	D3	L	L1 <sup>1</sup>	L2	L3	S1		
L	6	315	4	10	19	28	12	19	12	14	23	FI-WAS-06L-W2
	8	315	6	12	21	29	14	23	12	17	2,56	FI-WAS-08L-W2
	10	315	8	14	22	30	15	24	14	19	3,34	FI-WAS-10L-W2
	12	315	10	16	24	32	17	25	17	22	4,52	FI-WAS-12L-W2
	15	315	12	19	28	36	21	30	19	27	7,88	FI-WAS-15L-W2
	18	315	15	22	31	40	23,5	33	24	32	11,53	FI-WAS-18L-W2
	22	160	19	27	35	44	27,5	37	27	36	16,10	FI-WAS-22L-W2
	28	160	24	32	38	47	30,5	42	36	41	5,99	FI-WAS-28L-W2
	35	160	30	40	45	56	34,5	49	41	50	42,27	FI-WAS-35L-W2
	42	160	36	46	51	63	40	57	50	60	65,80	FI-WAS-42L-W2
S	6	400	4	11	23	30	16	23	12	17	30,96	FI-WAS-06S-W2
	8	400	5	13	24	31	17	24	14	19	43,75	FI-WAS-08S-W2
	10	400	7	15	25	33	17,5	25	17	22	56,74	FI-WAS-10S-W2
	12	400	8	17	29	38	21,5	29	17	24	8,03	FI-WAS-12S-W2
	14	400	10	19,3	30	40	22	30	19	27	9,89	FI-WAS-14S-W2
	16	400	12	21	33	43	24,5	33	24	30	13,89	FI-WAS-16S-W2
	20	400	16	26	37	48	26,5	37	27	36	20,24	FI-WAS-20S-W2
	25	400	20	31	42	54	30	42	36	46	35,01	FI-WAS-25S-W2
	30	400	25	36	49	62	35,5	49	41	50	53,00	FI-WAS-30S-W2
	38	315	32	44	57	72	41	57	50	60	83,70	FI-WAS-38S-W2

<sup>1</sup> Approximate dimension in assembled condition.

<sup>2</sup> Weight excluding cutting ring and union nut.

<sup>3</sup> Standard scope of delivery: Fitting body only.

**Ordering Codes**
**\*FI-WAS\*-10\*L\*-W159\*-MS**

* Elbow Weld Fitting		<b>FI-WAS</b>
* Outside Tube Diameter D1 (in mm)		<b>-10</b>
* Series	Light Series	<b>L</b>
	Heavy Series	<b>S</b>
* Material Code	Steel, phosphated	<b>-W2</b>
	Fitting body: Steel, phosphated	<b>-W159</b>
	Connecting parts: Steel, zinc/nickel-plated	
	Please contact STAUFF for alternative materials and surface finishings.	
* Assembling / Kitting	Fitting body only	<b>—</b>
	Fitting body supplied with cutting ring and union nut	<b>-MS</b>
	Fitting body supplied with soft-sealing cutting ring and union nut	<b>-MSV</b>

**Connecting Parts**

	Cutting Ring Type <b>FI-DS</b>	Page 28
	Soft-Sealing Cutting Ring Type <b>FI-WDDS</b>	Page 29
	Support Sleeve Type <b>FI-VH</b>	Page 31
	STAUFF Form EVO Sealing Ring Type <b>FI-FD</b>	Page 32
	Union Nut Type <b>FI-M</b>	Page 33
	37° Flared Tube Fitting Set Type <b>FI-AB</b>	Page 37

## 24° Weld Cone with O-Ring Type FI-SN ▪ Series L / S

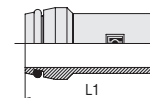
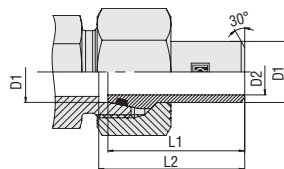

F

### Ordering Codes

#### \*FI-SN\*-10x1.5\*-B\*-W2

- \* 24° Weld Cone with O-Ring **FI-SN**
- \* Outside Tube Diameter (in mm) **-10**
- \* Wall Thickness (in mm) **x1.5**
- \* Seal Material NBR (Buna-N®) **-B**  
FKM (Viton®) **-V**
- \* Material Code Steel, phosphated **-W2**

Please contact STAUFF for alternative materials and surface finishings.

#### \*FI-SN\*-10\*L\*x1.5\*-B\*-W159\*-M

- \* 24° Weld Cone with O-Ring **FI-SN**
- \* Outside Tube Diameter (in mm) **-10**
- \* Series Light Series (page 116) **L**  
Heavy Series (pages 117) **S**
- \* Wall Thickness (in mm) **x1.5**
- \* Seal Material NBR (Buna-N®) **-B**  
FKM (Viton®) **-V**
- \* Material Code Weld cone: Steel, phosphated **-W159**  
Union nut: Steel, zinc/nickel-plated

Please contact STAUFF for alternative materials and surface finishings.

- \* Assembling / Kitting 24° weld cone with O-ring supplied with union nut **-M**

Series	Tube OD		PN bar	Dimensions			Weight kg ca. per 100	Ordering Codes <sup>3</sup>
	mm D1	for Tube		mm D2	L1	L2		
L/S	6	6 x 1,5	400	3	31	32	0,70	FI-SN-6x1.5-B-W2
	8	8 x 1,5	315	5	31	32	0,90	FI-SN-8x1.5-B-W2
	8	8 x 2,0	400	4	31	32	1,10	FI-SN-8x2-B-W2
	10	10 x 1,0	250	8	32,5	33,5	0,89	FI-SN-10x1-B-W2
	10	10 x 1,5	250	7	32,5	33,5	1,30	FI-SN-10x1.5-B-W2
	10	10 x 2,0	315	6	32,5	33,5	1,60	FI-SN-10x2-B-W2
	10	10 x 2,5	400	5	32,5	33,5	1,80	FI-SN-10x2.5-B-W2
	12	12 x 1,5	160	9	32,5	33,5	1,60	FI-SN-12x1.5-B-W2
	12	12 x 2,0	250	8	32,5	33,5	1,90	FI-SN-12x2-B-W2
	12	12 x 2,5	315	7	32,5	33,5	2,20	FI-SN-12x2.5-B-W2
	12	12 x 3,0	400	6	32,5	33,5	2,4	FI-SN-12x3-B-W2
	L	15	15 x 2,0	250	11	35	36	2,70
15		15 x 2,5	315	10	35	36	3,00	FI-SN-15x2.5-B-W2
18		18 x 2,0	160	14	36	37	3,76	FI-SN-18x2-B-W2
18		18 x 2,5	315	13	36	37	3,79	FI-SN-18x2.5-B-W2
22		22 x 2,0	160	18	38,5	39,5	4,46	FI-SN-22x2-B-W2
22		22 x 2,5	160	17	38,5	39,5	5,21	FI-SN-22x2.5-B-W2
22		22 x 3,0	160	16	38,5	39,5	5,72	FI-SN-22x3-B-W2
28		28 x 2,5	160	23	41,5	42,5	7,27	FI-SN-28x2.5-B-W2
28		28 x 3,0	160	22	41,5	42,5	8,34	FI-SN-28x3-B-W2
35		35 x 3,0	160	29	47	49,5	12,62	FI-SN-35x3-B-W2
35		35 x 3,5	160	28	47	49,5	14,05	FI-SN-35x3.5-B-W2
35		35 x 4,0	160	27	47	49,5	15,59	FI-SN-35x4-B-W2
42		42 x 3,0	160	36	47	50	15,13	FI-SN-42x3-B-W2
42		42 x 4,0	160	34	47	50	19,10	FI-SN-42x4-B-W2

<sup>1</sup> Approximate dimension in assembled condition.

<sup>2</sup> Weight excluding union nut.

<sup>3</sup> Standard scope of delivery: 24° weld cone and O-ring.

Standard seal material is NBR (Buna-N®).

### Connecting Parts



Union Nut  
Type **FI-M**

Page 33

### Spare Parts / Accessories



O-Ring  
Type **O-RING**

Page 239

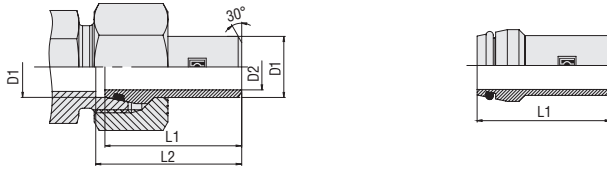
**24° Weld Cone with O-Ring  
Type FI-SN • Series S**

Series	Tube OD		PN bar	Dimensions			Weight kg ca. per 100	Ordering Codes <sup>3</sup>
	mm	for Tube		mm	L1	L2		
S	14	14 x 2,0	315	10	38,5	39,5	2,75	FI-SN-14x2-B-W2
	14	14 x 2,5	400	9	38,5	39,5	3,17	FI-SN-14x2.5-B-W2
	14	14 x 3,0	400	8	38,5	39,5	3,56	FI-SN-14x3-B-W2
	16	16 x 1,5	250	13	39	41	2,69	FI-SN-16x1.5-B-W2
	16	16 x 2,0	315	12	39	41	3,29	FI-SN-16x2-B-W2
	16	16 x 2,5	400	11	39	41	3,81	FI-SN-16x2.5-B-W2
	16	16 x 3,0	400	10	39	41	4,23	FI-SN-16x3-B-W2
	20	20 x 2,0	160	16	44,5	47	4,77	FI-SN-20x2-B-W2
	20	20 x 2,5	250	15	44,5	47	5,48	FI-SN-20x2.5-B-W2
	20	20 x 3,0	400	14	44,5	47	6,39	FI-SN-20x3-B-W2
	20	20 x 3,5	400	13	44,5	47	7,15	FI-SN-20x3.5-B-W2
	20	20 x 4,0	400	12	44,5	47	7,73	FI-SN-20x4-B-W2
	25	25 x 2,5	250	20	49,5	53,5	7,89	FI-SN-25x2.5-B-W2
	25	25 x 3,0	315	19	49,5	53,5	9,00	FI-SN-25x3-B-W2
	25	25 x 4,0	400	17	49,5	53,5	10,89	FI-SN-25x4-B-W2
	25	25 x 5,0	400	15	49,5	53,5	12,90	FI-SN-25x5-B-W2
	30	30 x 3,0	160	24	52	57,5	11,55	FI-SN-30x3-B-W2
	30	30 x 4,0	250	22	52	57,5	14,65	FI-SN-30x4-B-W2
	30	30 x 5,0	315	20	52	57,5	16,91	FI-SN-30x5-B-W2
	38	38 x 3,0	160	32	56,5	64,5	16,02	FI-SN-38x3-B-W2
38	38 x 4,0	315	30	56,5	64,5	20,29	FI-SN-38x4-B-W2	
38	38 x 5,0	315	28	56,5	64,5	24,05	FI-SN-38x5-B-W2	
38	38 x 6,0	315	26	56,5	64,5	27,91	FI-SN-38x6-B-W2	

<sup>1</sup> Approximate dimension in assembled condition.

<sup>2</sup> Weight excluding union nut.

<sup>3</sup> Standard scope of delivery: 24° weld cone and O-ring.

Standard seal material is NBR (Buna-N®).

**Ordering Codes**
**\*FI-SN\*-14x2\*-B\*-W2**

* 24° Weld Cone with O-Ring	FI-SN
* Outside Tube Diameter (in mm)	-14
* Wall Thickness (in mm)	x2
* Seal Material	NBR (Buna-N®) -B FKM (Viton®) -V
* Material Code	Steel, phosphated -W2

Please contact STAUFF for alternative materials and surface finishings.

**\*FI-SN\*-14Sx2\*-B\*-W159\*-M**

* 24° Weld Cone with O-Ring	FI-SN
* Outside Tube Diameter (in mm)	-14
* Wall Thickness (in mm)	x2
* Series	Light Series (page 116) L Heavy Series (pages 117) S
* Seal Material	NBR (Buna-N®) -B FKM (Viton®) -V
* Material Code	Weld cone: Steel, phosphated -W159 Union nut: Steel, zinc/nickel-plated

Please contact STAUFF for alternative materials and surface finishings.

\* Assembling / Kitting 24° weld cone with O-ring supplied with union nut -M

**Connecting Parts**

Union Nut  
Type FI-M

Page 33

**Spare Parts / Accessories**

O-Ring  
Type O-RING

Page 239

## 24° Weld Cone Reducer with O-Ring Type FI-SNR • Series L / S

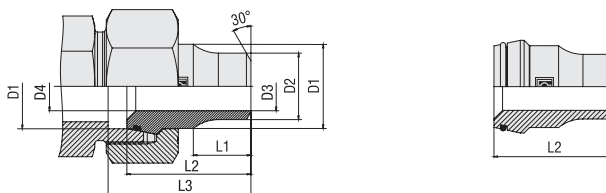

F

### Ordering Codes

#### \*FI-SNR\*-10/\*08\*x2.5\*-B\*-W2

- \* 24° Weld Cone Reducer with O-Ring FI-SNR
- \* Outside Tube Diameter D1 (in mm) -10/
- \* Outside Tube Diameter D2 (in mm) -08
- \* Wall Thickness (in mm) x2.5
- \* Seal Material -B  
NBR (Buna-N®)  
FKM (Viton®) -V
- \* Material Code -W2  
Steel, phosphated

Please contact STAUFF for alternative materials and surface finishings.

#### \*FI-SNR\*-10\*L/\*08\*x2.5\*-B\*-W159\*-M

- \* 24° Weld Cone Reducer with O-Ring FI-SNR
- \* Outside Tube Diameter D1 (in mm) -10
- \* Series L  
Light Series  
Heavy Series S
- \* Outside Tube Diameter D2 (in mm) -08
- \* Wall Thickness (in mm) x2.5
- \* Seal Material -B  
NBR (Buna-N®)  
FKM (Viton®) -V
- \* Material Code -W159  
Weld cone:  
Steel, phosphated  
Union nut:  
Steel, zinc/nickel-plated

Please contact STAUFF for alternative materials and surface finishings.

- \* Assembling / Kitting 24° weld cone with O-ring supplied with union nut -M

Series	Tube OD		PN bar	Dimensions						Weight kg ca. per 100	Ordering Codes <sup>3</sup>
	mm	for Tube		mm	D2	D3	D4	L1	L2		
L/S	8	6 x 2,0	400	6	2	5	12	31	32	1,45	FI-SNR-08/06x2-B-W2
	10	8 x 2,5	400	8	3	6,50	12	32,5	33,5	1,75	FI-SNR-10/08x2.5-B-W2
	12	10 x 3,0	400	10	4	8	14	32,5	33,5	2,19	FI-SNR-12/10x3-B-W2
S	14	12 x 3,5	400	12	5	9	15	38,5	39,5	3,56	FI-SNR-14/12x3.5-B-W2
	16	12 x 2,0	250	12	8	11	17	38,5	41	4,70	FI-SNR-16/12x2-B-W2
	20	12 x 3,5	400	12	5	14	17	44,5	47	8,55	FI-SNR-20/12x3.5-B-W2
	20	16 x 2,0	315	16	12	14	17	44,5	47	6,65	FI-SNR-20/16x2-B-W2
	20	16 x 3,0	315	16	10	14	17	44,5	47	7,73	FI-SNR-20/16x3-B-W2
	25	16 x 2,0	315	16	12	18	20	49,5	53	11,72	FI-SNR-25/16x2-B-W2
	25	16 x 3,0	315	16	10	18	20	49,5	53	12,96	FI-SNR-25/16x3-B-W2
	25	20 x 2,0	160	20	16	18	20	49,5	53	11,72	FI-SNR-25/20x2-B-W2
	25	20 x 4,0	400	20	12	18	20	49,5	53	12,82	FI-SNR-25/20x4-B-W2
	30	16 x 3,0	315	16	10	22	22	52	57,5	19,04	FI-SNR-30/16x3-B-W2
	30	20 x 4,0	315	20	12	22	22	52	57,5	19,31	FI-SNR-30/20x4-B-W2
	30	25 x 5,0	315	25	15	22	22	52	57,5	16,91	FI-SNR-30/25x5-B-W2
	38	16 x 3,0	315	16	10	30	26	56	62	29,79	FI-SNR-38/16x3-B-W2
	38	20 x 4,0	315	20	12	30	26	56	62	30,32	FI-SNR-38/20x4-B-W2
	38	25 x 5,0	315	25	15	30	26	56	62	30,95	FI-SNR-38/25x5-B-W2
38	30 x 4,0	315	30	22	30	26	56	62	26,36	FI-SNR-38/30x4-B-W2	

<sup>1</sup> Approximate dimension in assembled condition.

<sup>2</sup> Weight excluding union nut.

<sup>3</sup> Standard scope of delivery: 24° weld cone and O-ring.

Standard seal material is NBR (Buna-N®).

### Connecting Parts



Union Nut  
Type FI-M

Page 33

### Spare Parts / Accessories



O-Ring  
Type O-RING

Page 239

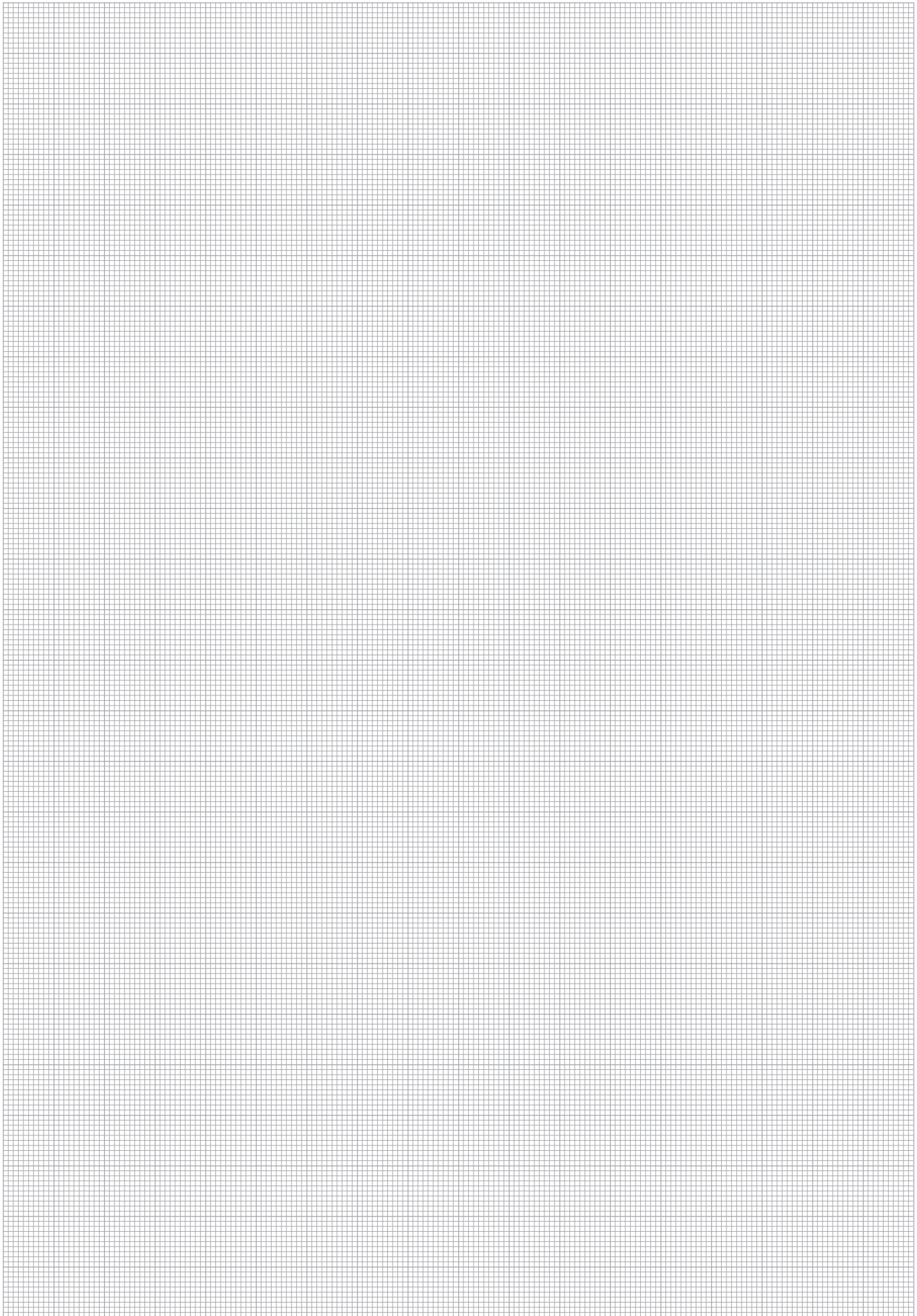

## Straight Weld Fitting for Tubes Type FI-ASV • Series S

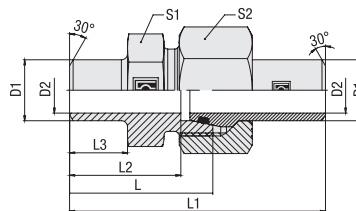

F

### Ordering Codes

**\*FI-ASV\*-06\*S\*x1.5\*-B\*-W159\*-MSN**

* Straight Weld Fitting for Tubes	<b>FI-ASV</b>
* Outside Tube Diameter (in mm)	<b>-06</b>
* Series	Heavy Series <b>S</b>
* Wall Thickness (in mm)	<b>x1.5</b>
* Seal Material	NBR (Buna-N®) <b>-B</b> FKM (Viton®) <b>-V</b>
* Material Code	Steel, phosphated <b>-W2</b>  Fitting body / weld cone: Steel, phosphated <b>-W159</b> Union nut: Steel, zinc/nickel-plated

Please contact STAUFF for alternative materials and surface finishings.

\* Assembling / Kitting Straight weld fitting for tubes supplied with 24° weld cone with O-ring and union nut **-MSN**

Series	Tube OD mm D1	for Tube	PN bar	Dimensions mm							Weight kg ca. per 100	Ordering Codes <sup>3</sup>
				D2	L	L1 <sup>1</sup>	L2	L3	S1	S2		
S	10	10 x 1,0	249	8	32	58	24,5	10	19	22	8,11	FI-ASV-10Sx1-B-W159-MSN
	10	10 x 1,5	358	7	32	58	24,5	10	19	22	8,54	FI-ASV-10Sx1.5-B-W159-MSN
	10	10 x 2,0	460	6	32	58	24,5	10	19	22	8,99	FI-ASV-10Sx2-B-W159-MSN
	12	12 x 1,5	305	9	37	63	29,5	15	22	24	10,47	FI-ASV-12Sx1.5-B-W159-MSN
	12	12 x 2,0	393	8	37	63	29,5	15	22	24	11,00	FI-ASV-12Sx2-B-W159-MSN
	12	12 x 2,5	476	7	37	63	29,5	15	22	24	11,54	FI-ASV-12Sx2.5-B-W159-MSN
	16	16 x 1,5	234	13	41,5	74	33	16,5	27	30	17,40	FI-ASV-16Sx1.5-B-W159-MSN
	16	16 x 2,0	305	12	41,5	74	33	16,5	27	30	18,30	FI-ASV-16Sx2-B-W159-MSN
	16	16 x 2,5	372	11	41,5	74	33	16,5	27	30	19,27	FI-ASV-16Sx2.5-B-W159-MSN
	16	16 x 3,0	400	10	41,5	74	33	16,5	27	30	20,09	FI-ASV-16Sx3-B-W159-MSN
	20	20 x 2,0	249	16	47	84	36,5	19	32	36	28,18	FI-ASV-20Sx2-B-W159-MSN
	20	20 x 2,5	305	15	47	84	36,5	19	32	36	29,67	FI-ASV-20Sx2.5-B-W159-MSN
	20	20 x 3,0	358	14	47	84	36,5	19	32	36	31,08	FI-ASV-20Sx3-B-W159-MSN
	20	20 x 4,0	400	12	47	84	36,5	19	32	36	33,10	FI-ASV-20Sx4-B-W159-MSN
	25	25 x 3,0	294	19	51,5	93	39,5	19,5	41	46	53,44	FI-ASV-25Sx3-B-W159-MSN
	25	25 x 4,0	379	17	51,5	93	39,5	19,5	41	46	57,29	FI-ASV-25Sx4-B-W159-MSN
	25	25 x 5,0	400	15	51,5	93	39,5	19,5	41	46	59,90	FI-ASV-25Sx5-B-W159-MSN
	30	30 x 3,0	249	24	58	102	44,5	23	46	50	66,38	FI-ASV-30Sx3-B-W159-MSN
	30	30 x 4,0	323	22	58	102	44,5	23	46	50	71,62	FI-ASV-30Sx4-B-W159-MSN
	30	30 x 5,0	393	20	58	102	44,5	23	46	50	75,33	FI-ASV-30Sx5-B-W159-MSN
30	30 x 6,0	400	18	58	102	44,5	23	46	50	79,03	FI-ASV-30Sx6-B-W159-MSN	
38	38 x 4,0	261	30	60	109	44	22	55	60	102,93	FI-ASV-38Sx4-B-W159-MSN	
38	38 x 5,0	315	28	60	109	44	22	55	60	108,61	FI-ASV-38Sx5-B-W159-MSN	
38	38 x 6,0	315	26	60	109	44	22	55	60	114,48	FI-ASV-38Sx6-B-W159-MSN	
38	38 x 7,0	315	24	60	109	44	22	55	60	119,83	FI-ASV-38Sx7-B-W159-MSN	

### Connecting Parts



Union Nut  
Type **FI-M**

Page 33

### Spare Parts / Accessories



O-Ring  
Type **O-RING**

Page 239

<sup>1</sup> Approximate dimension in assembled condition.

<sup>2</sup> Weight including 24° weld cone and union nut.

<sup>3</sup> Standard scope of delivery:  
24° weld cone, O-ring and union nut.

Standard seal material is NBR (Buna-N®).

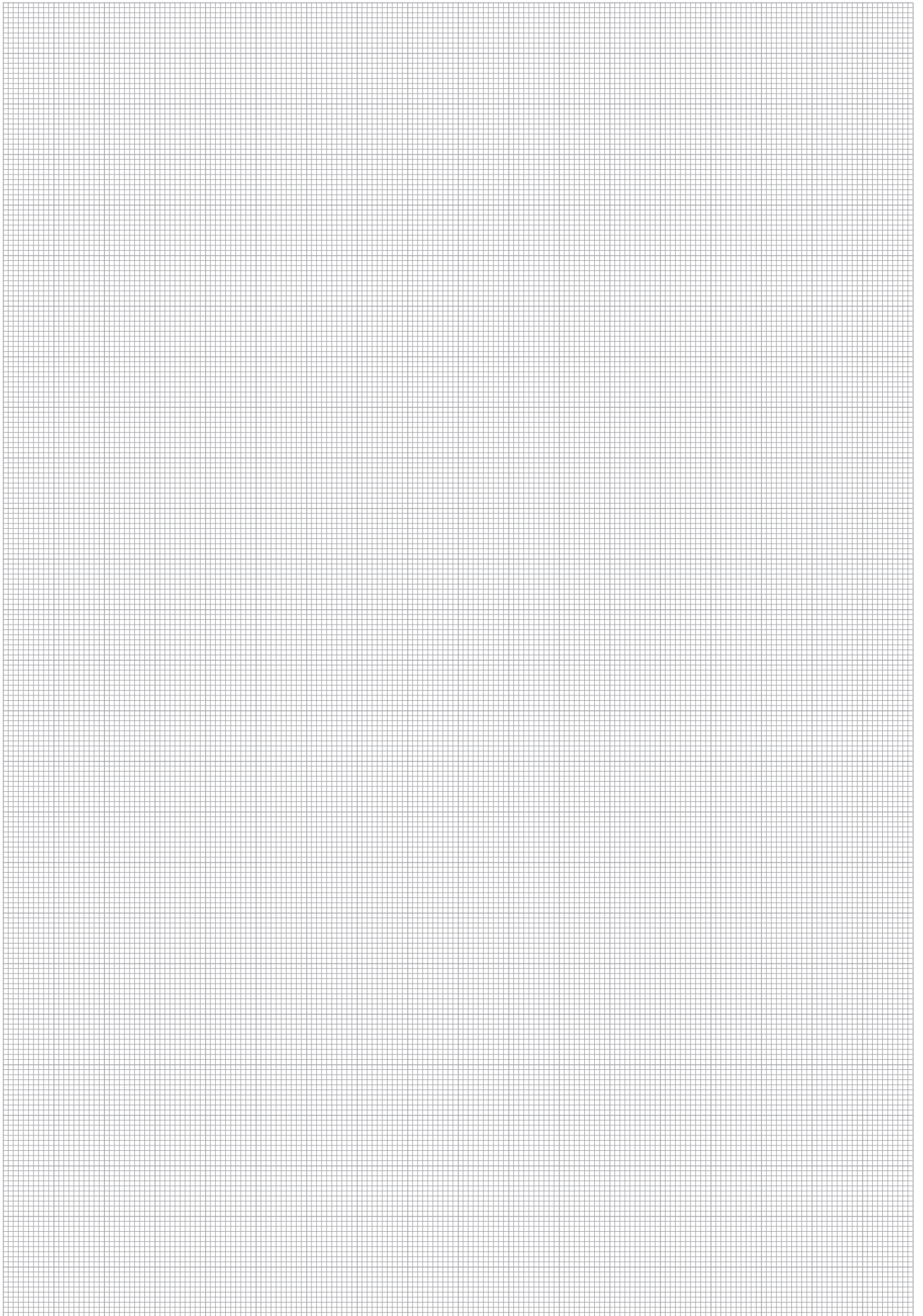

F